



ERNIE ELS
ELS FOR AUTISM

**EXCELLENCE
AHEAD**



ERNIE ELS
ELS FOR AUTISM

THE STOOPS FAMILY FOUNDATION ADULT SERVICES BUILDING



*"The Adult Services building will be a place where adults can explore different careers, make friends, and engage with the community."
~ Liezl Els, Co-Founder*





EXCELLENCE AHEAD: THE STOOPS FAMILY FOUNDATION ADULT SERVICES BUILDING A PLACE FOR ADULTS WITH AUTISM

According to a 2021 report by the U.S. Department of Labor, when young adults with autism spectrum disorder (ASD) graduate from high school, many have a difficult time developing a post-secondary education, gaining paid employment, learning independent living skills, participating in community activities, and gaining access to services including healthcare.

To provide life-span programs and services to help individuals with autism successfully transition to adulthood, Els for Autism is constructing (1st quarter 2022), as part of The Els Center of Excellence campus build-out, The Stoops Family Foundation Adult Services Building. This on-campus space will provide transition-aged students and adults exiting the school system programs and services in the areas of:

Employment Services, Therapeutic Services, Day Training, Recreation & Social

For more information about the Stoops Family Foundation Adult Services Building and to learn how you can make a lasting impact on this leading-edge space for adults with autism, please scan the QR Code:



ON THE CAMPUS

at The Els Center of Excellence®

Located in Jupiter, FL, The Els Center of Excellence integrates unique architectural components to create an environment designed specifically for children, teens, and adults on the autism spectrum. The 26-acre campus is currently comprised of four buildings:

- **The Els Center of Excellence Administrative Building** - auditorium and conference center
- **The Rupert Education Wing** - Early Intervention Program, Therapeutic Services, and The Learning Center, a tuition-free, Palm Beach County charter school (ages 3-14)
- **The Shanken Education Wing** - Adult Services Programs and The Learning Academy, a tuition-free Palm Beach County charter school (ages 14-21)
- **The O'Donnell Family Pavilion** - gathering center for art shows, events, and other meetings



THE STOOPS FAMILY FOUNDATION ADULT SERVICES BUILDING

A new 21,000 square foot construction project designed in partnership with Collins Development Company and the architect firm, Spina O'Rourke + Partners. The building has been specifically designed to meet the needs of adults with autism by incorporating unique architectural elements including:

- State-of-the-art technology; interactive whiteboards, video cameras for observation and video conferencing
- Acoustiblock liner installed within the walls throughout the building to reduce noise transmissions
- Use of LED lighting throughout the building to reduce behavioral responses
- Quiet nooks in hallways
- Overall floor plan designed to promote safety, accessibility, and independence
- Neutral color palette throughout to create a calming yet engaging atmosphere

ADULT SERVICES FOCUS

at The Els Center of Excellence™



Employment Training, Support, and Placement

Job assessment, job training/coaching, and job opportunities with corporate and organizational employment partners are provided in the community and on campus. Vocational training labs focus on retail, grocery, business and food services skills, including a café with a drive-through window and gift shop area.

Day Training Program

Tailored for individuals whose primary needs are socialization, recreation, prevocational skills, and community involvement. This program will build on each participant's individualized strengths supporting the development and practice of social skills, independent living skills, safety skills, and engagement so that they can achieve greater independence and live a meaningful and fulfilling life.

Self-Advocacy

The Foundation's staff works with individuals to create "individual life plans." Regular reviews with the individual and family are conducted to track progress toward set goals.

Recreational and Social Services

Activities in other areas of the campus include recreation services and therapeutic arts programs, along with other programs to promote social interaction and health goals.

Supported Living

Therapy rooms with a shared living/dining area serve as training areas for individuals with autism spectrum disorder to learn independent living skills.

Post-graduation

Delivery of vocational and independent living skills to support adults with autism in their transition to meaningful job opportunities.

Microbusiness

Sea of Possibilities, an Els for Autism microbusiness, empowers adults to create, market, and sell artwork items collected from the beach and ocean, and opens many opportunities for adults to learn transferable business skills and practice their customer service interactions, communication, money skills, and product creation.

***For more information about our programs, please contact Program Director
Dr. Erin Brooker Lozott at 561-320-9521 or erin.lozott@elsforautism.org***

FIRST FLOOR NAMING OPPORTUNITIES

at The Els Center of Excellence®

The Stoops Family Foundation Adult Services building will be a place where adults can find guidance and direction as they navigate their future. It will be a space where they can continue to develop friendships and receive specialized support while pursuing their dreams and aspirations.

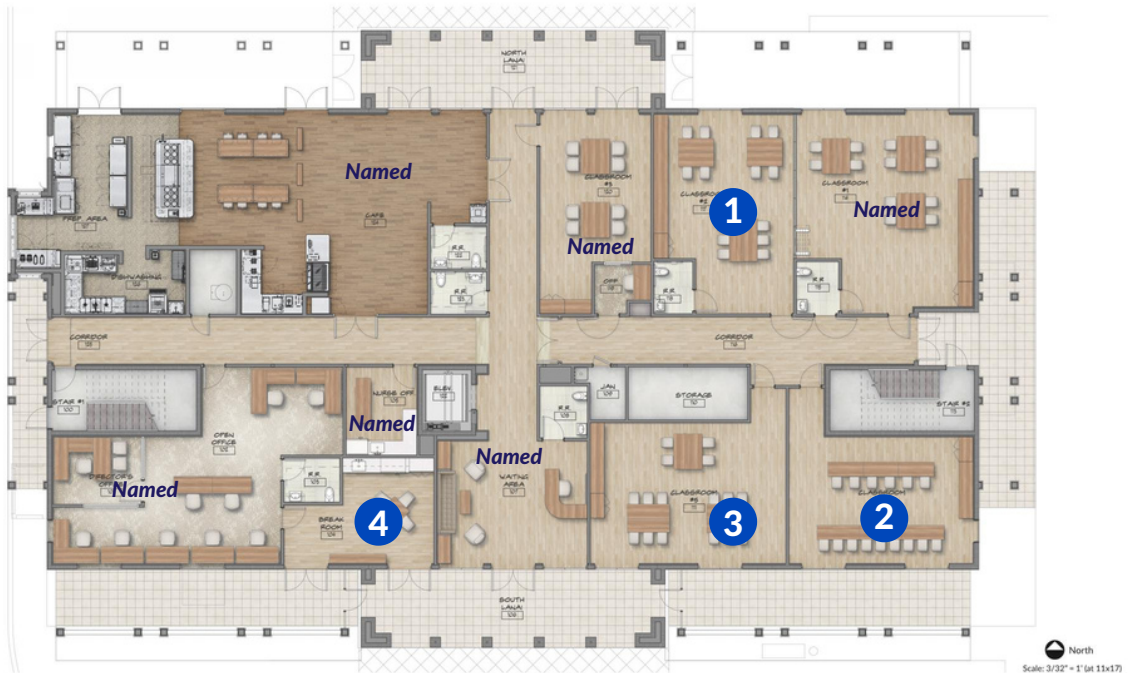

First Floor Plan

First Floor Naming Opportunities

- 1 \$100K Classroom #2
- 2 \$100K Classroom #4
- 3 \$100K Classroom #5
- 4 \$50K Employee Lounge/Breakroom

SECOND FLOOR NAMING OPPORTUNITIES

at The Els Center of Excellence®



Second Floor Plan

Second Floor Naming Opportunities

- | | |
|--|--|
| 1 \$250K Two-bedroom Suite | 5 \$100K Golf Shop/Retail Vocational Lab |
| 2 \$250K Activity Room | 6 \$100K Grocery Vocational Lab |
| 3 \$250K Vocational Skills Room | 7 \$100K Business Vocational Lab |
| 4 \$250K Work Readiness and
Daily Living Room | 8 \$50K Observation Room |
| | 9 \$50K Day Program Coordinator Office |
| | 10 \$50K Breakroom |

If you are interested in discussing a naming opportunity please contact our Development Office at 561-598-6197 or development@elsforautism.org.

CAPITAL CAMPAIGN CALL FOR IN KIND DONATIONS

at The Els Center of Excellence®

Full-Service Café

The Adult Services building will be outfitted with a commercial kitchen, thanks to the design expertise of Cheney Brothers. The kitchen will be at the heart of a full-service café with drive-through service, along with indoor and outdoor seating. The café will provide program participants with opportunities to learn and practice the job skills needed to work in the foodservice industry and employment opportunities for adults on the autism spectrum.

In-Kind Support Opportunities:
*food service equipment &
indoor / outdoor furniture*



Two-Bedroom Suite

Staged as an apartment or hotel room, this space is dedicated to enhanced life skills and vocational training. The space includes two bedrooms, a bathroom, a living room, and a laundry room and will provide an opportunity to learn daily living skills for all clients, especially those with the goal of living on their own. Along with the three therapy rooms on the second floor, the space can also be utilized for mental health counseling and speech and language therapy.

In-Kind Support Opportunities:
furnishings



Classrooms

Five classrooms on the first floor will provide space for our Adult Day Training Program which will include training in the areas of vocational skills, social skills, independent living skills, and safety skills. One classroom will serve as a workroom for the Adult Day Training microbusiness, Sea of Possibilities.

In-Kind Support Opportunities:
printers, laptops, smart boards





Reception

Beginning with a welcoming reception area, the Adult Services building will create a safe and dedicated space for adults on the campus once they graduate high school.

***In-Kind Support Opportunities:**
furnishings &
technology equipment*



Golf Pro Shop/Retail Storefront

A Golf Pro Shop Vocational Lab will provide opportunities to learn retail industry-specific skills and ways to demonstrate abilities that will add value to core business operations.

***In-Kind Support Opportunities:**
store inventory & equipment
furniture*



Grocery & Business Storefront

Grocery & Business Vocational Labs will provide learning opportunities in industry-specific work skills in each field in addition to "soft skills" needed to obtain and maintain employment in each industry.

***In-Kind Support Opportunities:**
merchandising equipment, furniture,
store inventory & technology equipment*

Other In-Kind Needs

***Landscaping
Kitchen Equipment
Window Treatments***

***HVAC
Plumbing
Security Cameras***

***Smartboards
Laptops
Printers and Phones***

If you are interested in providing an in-kind donation for the building, please contact our Development Office at 561-598-6197 or development@elsforautism.org.

Why #ExcellenceAhead?

1 in 44 people

receive an **autism diagnosis**, and of these individuals with autism:

adult independence

is a **parent's greatest concern** when their child "ages out" of services

over 70,000 turn 18 years old every single year.



individuals with autism have difficulties finding eligible opportunities for continuing support.

when aging out of the school system, adults with autism need access to a variety of support such as:

- ✓ **a transition plan**
- ✓ **recreation activities**
- ✓ **work programs**
- ✓ **career support**
- ✓ **continuing education and therapies**

Adults with autism are known to contribute greatly in their employment settings, yet **75 percent of these individuals are without employment.**

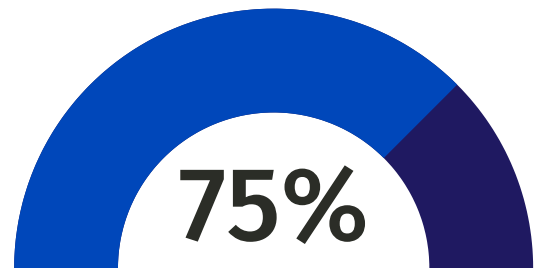

The Stoops Family Foundation Adult Services Building will be a space for:

- enhancing employer and business partnerships
- delivering programs and services directly to adults with autism in the areas of Employment Services, Therapeutic Services, Day Training, Recreation & Social.
- disseminating best practices around the world



ELS FOR AUTISM BOARD OF DIRECTORS

OFFICERS

MARVIN R. SHANKEN (CHAIRMAN)

FOUNDER, ELS FOR AUTISM FOUNDATION

PUBLISHER & FOUNDER OF M.SHANKEN COMMUNICATIONS

LIEZL ELS (SECRETARY AND MANAGING DIRECTOR)

FOUNDER, ELS FOR AUTISM FOUNDATION

BOARD MEMBERS

ERNIE ELS

FOUNDER, ELS FOR AUTISM FOUNDATION

DR. MICHAEL ALESSANDRI

EXECUTIVE DIRECTOR, UNIVERSITY OF MIAMI CENTER FOR AUTISM AND RELATED DISABILITIES

CINDY CHRISTY-LANGENFELD

PRESIDENT, ASURION

GIUSEPPE CIUCCI

CHIEF EXECUTIVE, CHAIRMAN OF THE BOARD STONEHAGE LIMITED

PATRICK MCMAHON

FOUNDER, CHIEF EXECUTIVE OFFICER

CO-CHIEF INVESTMENT OFFICER, MKP CAPITAL MANAGEMENT, LLC

PAMELA MINELLI

CO-FOUNDER OF THE AUTISM PROJECT OF PALM BEACH COUNTY

STEVE PECK

SAP GLOBAL ALLIANCE RELATIONSHIP LEADER, EY

STUART MAKIN (TREASURER)

PARTNER, STONEHAGE LIMITED; NON-VOTING MEMBER

EXECUTIVE LEADERSHIP

DR. MARLENE SOTELO

EXECUTIVE DIRECTOR, ELS FOR AUTISM FOUNDATION

YVONNE D'AMELIO

CHIEF FINANCIAL OFFICER, ELS FOR AUTISM FOUNDATION

*For more information, please contact our Capital Campaign co-chairs
Pam Minelli at pminelli@comcast.net and Cindy Christy-Langenfeld at CindyCL1997@aol.com.*

MAKE A LASTING IMPACT



*Scan the QR Code
or visit elsforautism.org/adults*