



**ERNIE ELS  
ELS FOR AUTISM®**



## **CORPORATE PARTNER INCENTIVE PROGRAM**

Elevate Your Impact with Els for Autism®

Supporting the Els for Autism Capital Campaign to build an  
Autism Friendly Recreation Complex

# ABOUT ELS FOR AUTISM

*Where Possibilities are Endless*



Els for Autism was established in 2009 by Former World No.1, World Golf Hall of Famer, and four-time Major Champion, Ernie Els, his wife, Liezl, and Publisher and Founder of M. Shanken Communications Marvin R. Shanken. The Els' son, Ben, is impacted by autism, which affects 1 in 31 children in the United States\*. The Els' daughter, Samantha (Sam), also plays an active role in the organization as the co-founder of our sibling support group, Sam's Sibs Stick Together.

Els for Autism offers innovative, evidence-based programs for families and individuals across the lifespan in three primary impact areas: Early Intervention & Educational Services, Recreation Services, and Adult Services.



We serve families around the world, offering virtual services and in-person programs and services at The Els Center of Excellence campus in Jupiter, Florida. The center is a world-class, 26-acre campus that is home to two separate nonprofit organizations: Els for Autism and The Learning Academy, a tuition-free, nonprofit Palm Beach County public charter school serving students with ASD ages 3 to 21.

\*Based on data published by the Centers for Disease Control and Prevention (CDC) in 2025



# ABOUT THE PROJECT

*A Transformative Health and Safety Initiative*



The Els Center of Excellence® in Jupiter, FL is dedicated to empowering individuals with autism to lead healthy, active, and fulfilling lives. While our campus already features a range of outdoor sports and recreation spaces, we recognize that true health and well-being require consistent, year-round access to fitness, sports, and life skills programming—regardless of weather, time of day, or season.



Many individuals with autism face significant barriers to accessing traditional fitness and recreation programs, resulting in higher rates of obesity, diabetes, and other preventable health challenges. Our new Specialized Autism Friendly Recreation Complex will break down these barriers, providing a safe, supportive, and sensory-friendly environment where individuals of all ages and abilities can develop lifelong habits of health, fitness, and social connection.

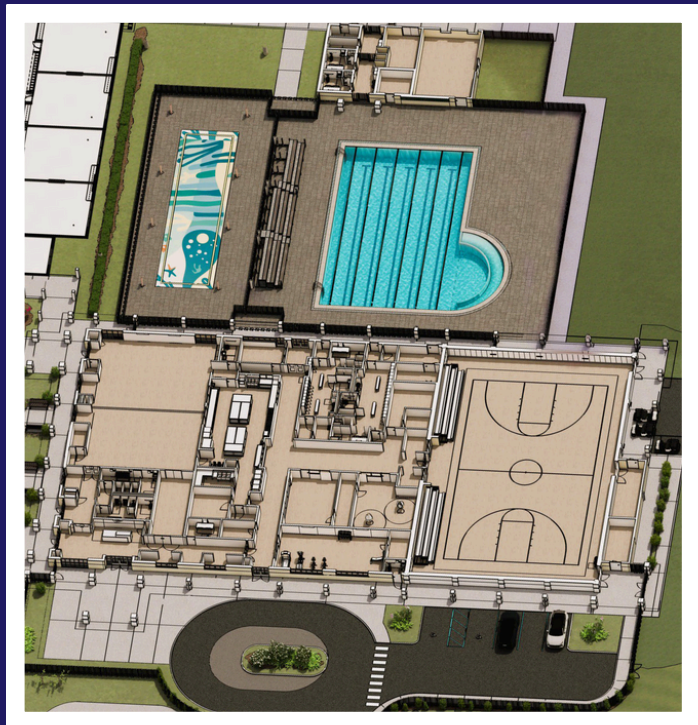



# A LIFE-SAVING AQUATIC CENTER

*Preventing Tragedy, Building Confidence*

Drowning is the #1 cause of death for young children with autism, and Florida tragically leads the nation in autism-related drownings. Wandering and water fascination are common among children on the spectrum, making water safety education not just beneficial, but absolutely essential.



**Our new Aquatic Center will be a cornerstone of the Recreation Complex, offering:**

- **Specialized Water Safety Instruction:** Evidence-based, autism-specific swim lessons and water safety programs delivered by highly trained instructors.
- **Year-Round Access:** A temperature-controlled environment ensures consistent instruction and practice, regardless of season.
- **Family and Community Education:** Workshops and resources for families and caregivers to reinforce water safety skills at home and in the community.

By equipping individuals with autism—and their families—with critical water safety skills, we are not only promoting health and recreation but also saving lives.



# WHY THIS COMPLEX IS ESSENTIAL

*Transforming Health Outcomes*

- **Year-Round Fitness:** The Recreation Complex will provide daily access to sports, fitness, and wellness programs—promoting healthy, independent living.
- **Comprehensive Life Skills:** Programs like our Food Industry Curriculum and the Ernie Els #GameON Autism® Sports Program support physical, social, and vocational development.
- **Replicable Model:** This facility will become a global model for autism-friendly recreation, expanding our reach far beyond Jupiter, FL.

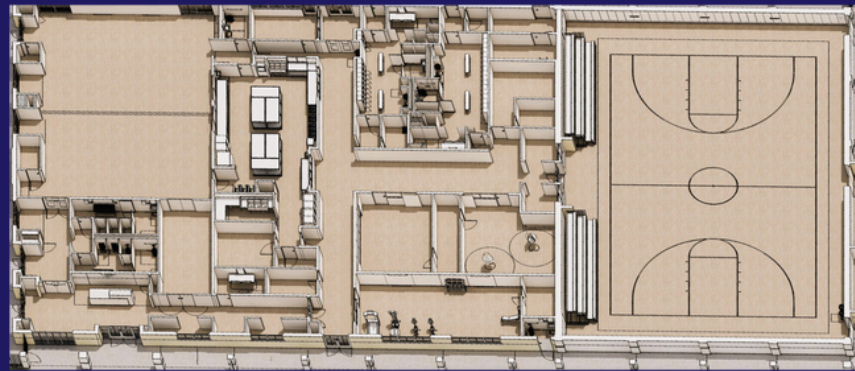

## SAFETY, INCLUSION, AND EMPOWERMENT

- **ASPECTSS® Design:** Built for sensory safety and inclusion, the complex will set a new national benchmark for accessible recreation.
- **Lifesaving Skills:** The Aquatic Center will address the leading cause of accidental death among children with autism—providing life-saving impact locally and beyond.

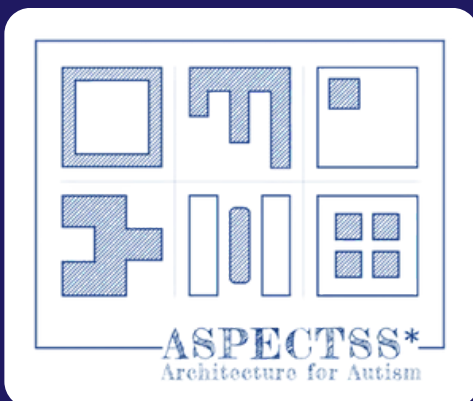

### ACOUSTICS

The strategic use of specially designed materials to reduce echoes and limit noise transfer between spaces.

### SPATIAL SEQUENCING

An organization of the spaces and rooms of the building to flow in a predictable manner.

### ESCAPE SPACES

For sensory respite and regulation, these are from within a space and allow for needed sensory regulation without isolation from social activities and engagement with the group.

### COMPARTMENTALIZATION

A logical subdivision and organization of spaces to limit sensory overload and distractions.

### TRANSITION SPACES

In a gradient of sensory opportunity and level of enclosure, transition spaces allow preparation prior to entering activities

### SENSORY PERCHES

Intended to help support predictability, planning, comfort and reduced anxiety prior to engaging in gym activities

### SENSORY ZONING

An organization of the design of the building in a manner that clusters quiet activities away from high sensory stimulation areas

### SAFETY

The building is organized with a single main entry point to allow maximum supervision, with controlled exits with clear sight lines and double control points leading to the water area.



# CORPORATE PARTNERSHIP VISIBILITY, IMPACT, AND LEGACY

*Why Partner with Us?*

- **Tangible Impact:** Your support will improve the lives of thousands of individuals with autism and their families—locally and globally—while advancing inclusion in recreation.
- **Brand Visibility:** Partners receive recognition through naming opportunities, media, and campaign communications—aligning your brand with a nationally recognized project.
- **Employee Engagement:** Supporting autism initiatives fosters employee pride, loyalty, and stronger team culture.
- **Customer Loyalty:** Today's consumers value brands that lead with purpose. Partnering with Els for Autism signals a genuine commitment to inclusion.
- **Thought Leadership:** As a founding partner, your company will be recognized as a leader in neurodiversity and inclusion.
- **Tax Benefits and Corporate Giving Incentives:** Els for Autism is a registered 501(c)(3) nonprofit organization. Contributions may be eligible for tax benefits and corporate giving incentives. Donors are encouraged to consult with their tax advisor to determine the full extent of these benefits in connection with their contributions.
- **Social Return on Investment (SROI):** Aligning with a mission-driven organization strengthens brand loyalty and delivers measurable SROI, helping drive customer retention and revenue growth.





# JOIN OUR CORPORATE PARTNER INCENTIVE PROGRAM

## WAYS TO PARTNER

To bring this project to life, we invite companies to support the Recreation Complex through one of the following ways:

- **In-Kind Contributions:** Donate materials, labor, or services essential to the project's construction and operation.
- **Discounted Services:** Offer your company's expertise or goods at a reduced rate, maximizing the impact of every dollar raised.
- **Financial Donations:** Direct gifts move us closer to our \$20 million goal and unlock even greater impact.

All partners will be recognized according to the total value of their contribution (in-kind, discounted services, and/or financial donation), with additional opportunities for ongoing engagement as the Recreation Complex opens.



**SCAN OR CLICK TO DONATE NOW**



# RECOGNITION LEVELS:

## COMMUNITY PARTNER

Minimum Contribution: \$5,000 (in-kind or financial)

- Logo placement on the campaign webpage with hyperlink
- Social media thank-you post

## BUILDER PARTNER

Minimum Contribution: \$20,000 (in-kind or financial)

- All Community Partner benefits
- Company logo featured in the quarterly e-newsletter
- Two complimentary tickets to Neon Nights (if committed by Aug. 1, 2025)
- Logo placement on Groundbreaking Ceremony event signage (if committed by Aug. 1, 2025)
- Opportunity to provide branded items for donor events associated with the Recreation Complex

## CORNERSTONE PARTNER

Minimum Contribution: \$50,000 (in-kind or financial)

- All Builder Partner benefits
- Company feature in a donor spotlight story in our GameChanger newsletter
- Certificate of appreciation signed by Ernie Els
- Company banner placement on construction fencing
- Invitation to a private hard hat tour of the complex
- VIP invitation to the official Groundbreaking Ceremony (if committed by Aug. 1, 2025)

## VISIONARY PARTNER

Minimum Contribution: \$100,000 (in-kind or financial)

- All Cornerstone Partner benefits
- Room naming opportunity within the Recreation Complex
- Joint press announcement or co-branded media opportunity
- Opportunity to speak or be formally recognized at the Groundbreaking Ceremony (if committed by Aug. 1, 2025)



# FOR MORE INFORMATION AND RECOGNITION LEVELS CONTACT:

## PAIGE THOMAS

Director of Development and Marketing  
[paige.thomas@elsforautism.org](mailto:paige.thomas@elsforautism.org)  
561-320-9532

## ROBERT KIMMEL

Sr. Manager, Construction and Facilities  
[robert.kimmel@elsforautism.org](mailto:robert.kimmel@elsforautism.org)  
561-320-9534



**ERNIE ELS**  
**ELS FOR AUTISM®**

“Recreation and water safety are not luxuries—they are necessities  
for a healthy, fulfilling, and safe life for people with autism.  
Join us in making this vision a reality.”